



twinsummercentres.com
+44 (0) 20 8269 5678



Twin Summer Centres

Centres in the UK and Ireland

2024



Welcome to Twin Summer Centres

We have been growing our expertise for more than 27 years, and continue to provide exciting and unforgettable opportunities for learners from around the world. We have come a long way since we first opened our doors, giving thousands of students memorable experiences while improving their English language skills. Get ready to embark on an exciting journey of language learning with us, in one of our carefully selected summer locations!



“After a record-breaking 2023 summer season, we are delighted to add two exciting new summer centre locations to our 2024 offer – Edinburgh and Kingston upon Thames. At Twin, our iconic locations across the UK and Ireland will be sure to excite and inspire a whole new cohort of students. We look forward to welcoming them and growing opportunity in life experiences for all.

- Caroline & Jacqui Fox - Founders



To view our other products visit us at:



English Centres



Internships



School Group Travel

Twin's commitment to safeguarding

The safety and well-being of students is our highest priority. Our centres are accredited, and our safeguarding standards are enforced with the following:

- 24-hour emergency contact number
- All activities and excursions adhere to adult to child supervision ratios of:
 - 9-12 years – One adult to eight children
 - 13-18 years – One adult to ten children
- Individual students assigned to a dedicated Twin Group Leader
- Safeguarding Lead on duty in each centre at all times
- Staff recruitment is carried out by staff trained in NSPCC Safer Recruitment course
- Enhanced DBS, Garda vetting, or other country-specific police checks are carried out on all staff



Growing Opportunity in Life Experiences

Contents

| | |
|---------------------------|----|
| The summer at Twin | 04 |
| English programmes | 06 |
| Discover London programme | 08 |
| Added values packages | 10 |
| London centres | |
| London Docklands | 12 |
| London Kingston | 13 |
| Irish centres | |
| Dublin | 14 |
| Waterford | 15 |
| Other UK centres | |
| Royal Leamington Spa | 16 |
| Eastbourne | 17 |
| Edinburgh | 18 |
| Accommodation | 22 |
| Extra services | 23 |

NEW - Added value at every level!

This year we are splitting our two-week (13 night) packages into different tiers.



Platinum



Gold



Silver



Bronze

This helps you book the perfect programme for you; as light or as intense as you want it to be - See Page 10 for details.



Your summer starts here!

Our summer programmes combine learning, exploration and action-packed opportunities, across the UK and Ireland.

We have seven summer centres, with two new for 2024 - Kingston upon Thames, and Edinburgh. All of our centres are selected especially for their locations, facilities, and welcoming atmospheres.

Because we know that different people benefit from different environments, students can study with us in vibrant cities, seaside towns or rural settings across the UK and Ireland.

As always, our goal is to engage and educate students through a syllabus of English tuition and exciting activities. We have British Council accredited tuition in the UK, and ACELS accreditation in Ireland. We also offer a variety of excursion destinations and activities to choose from.

Locations

Summer Centres UK & Ireland

- ① London Docklands (page 12)
- ② Kingston upon Thames (page 13)
- ③ Dublin (page 14)
- ④ Waterford (page 15)
- ⑤ Royal Leamington Spa (page 16)
- ⑥ Eastbourne (page 17)
- ⑦ Edinburgh (page 18)

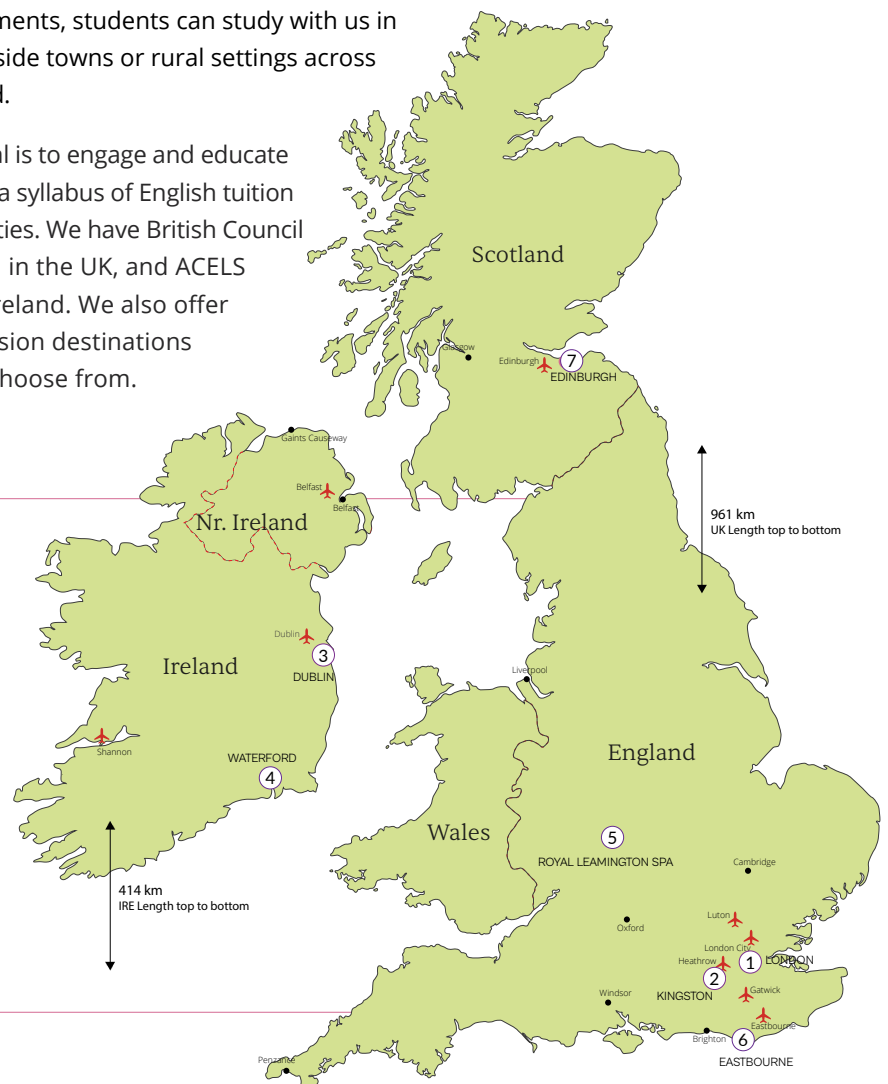

An action-packed, unforgettable summer experience



Summer tuition and activities

Our summer programmes are developed to offer enjoyable student experiences by combining tuition with comfortable accommodation, exciting activities, and excursions.

We use the communicative teaching method and project work to create a fun and entertaining teaching approach for students. Our courses help them learn language skills they can use outside of the classroom, in the real world.

Our teachers help students to:

- Develop their English skills
- Build their confidence using and understanding English
- Improve their pronunciation and expand their vocabulary

Activities

We design our activities to support our tuition. The activity programme aims to ensure that every student has an enjoyable experience while encouraging them to practise their English outside of the classroom. Sports, arts and crafts, photography club, and scavenger hunts are just some activities that keep them busy in-between lessons.

We also have team games and activities to keep students busy during the evening hours. Students can dance the evenings away at discos, show off their more competitive side at quiz nights, or socialise with their new friends at a talent show or a film night.



Student excursions

Students have the chance to see more of the UK or Ireland with exciting weekly excursions. These vary by centre, and students can visit popular and historic areas, such as Oxford, Brighton, Cambridge, Glendalough, Ardgillan or Skerries to discover more about the history and culture of the UK or Ireland. Our excursions and activities are linked to the lesson plans and give students more opportunities to socialise while practising their new language skills.



Something for everyone

Two exciting English programmes to choose from

We offer two English programmes in our summer centres – ‘Discover London’ at our two London centres with zig-zag courses (alternative days teaching / sightseeing) and walking tours, and the ‘Standard Programme’ at all our other centres.

The Standard Programme

Combining high-quality English language learning with activities and excursions each day, our Standard English programme is a great choice for students looking to get a little of everything out of their stay. Lessons (15 hours a week) take place in the morning, with trips and activities after lunch and in the evenings.

Each of our summer centres have a range of different activities scheduled each week. See overpage for a typical week at a Twin summer centre outside of London.

Our English Programmes

| Programme | Centre | Lessons | Minimum English Level | Max Class Size | Age | Country | Accommodation Option |
|--------------------|--|---------|-----------------------|----------------|------------------|-------------|----------------------|
| Standard Programme | Eastbourne, Leamington Spa, Dublin, Waterford, Edinburgh | 15 | Elementary | 16 | Varies by centre | UK, Ireland | Varies by centre |
| Discover London | London Docklands, London Kingston | 15 | Elementary | 16 | 11-18 | UK | Residential |

A range of courses, tailored to your needs

A typical week at a Twin Summer Centre outside London

Day 1 Student arrival



Morning - Meet & greet, orientation tour

Afternoon - Walking tour of the local area

Evening - Welcome evening with fun and games

Day 2 Student induction



Morning - Student induction and language testing

Afternoon - Campus scavenger hunt!

Evening - Students get together for competition time!

Day 3 Lessons begin!



Morning - Teaching time (English lessons)

Afternoon - Half day excursion (various locations)

Evening - Get your thinking caps on for a Twin quiz night!

Day 4 Half-day excursion/tour



Morning - Teaching time

Afternoon - Half-day excursion (various locations)

Evening - Who did it? Twin murder mystery!

Day 5 Lessons and activities



Morning - Teaching time (English lessons)

Afternoon - Sports tournament

Evening - Dance away at a Twin disco!

Day 6 Full-day excursion/tour



Morning/Afternoon - Full-day excursion (various locations)

Evening - Grab the popcorn and settle down for film night

A range of activities and excursions with English tuition



Discover London Programme

At London Docklands and Kingston upon Thames

One of the most popular tourist destinations in the world, London easily blends rich history with modern culture, offering an unforgettable experience for international students. Explore iconic landmarks like Elizabeth Tower (widely known as Big Ben, which actually is the name of the bell inside), Tower Bridge, and Buckingham Palace, each telling its own unique story.

Our Discover London programme is available at both our exciting 2024 London summer centres, at London Docklands and Kingston upon Thames. Through a number of carefully planned walking tours, this programme is perfect for students who want to see all the iconic sights of London.

Students will alternate their days between English tuition and sightseeing, with lessons following the same syllabus as our Standard Programme. This is a great opportunity for students to practise using the skills they have developed in lessons when they are out enjoying the sights.

Sample Programme - Discover London

| Time | Day 1 | Day 2 | Day 3 | Day 4 | Day 5 | Day 6 | Day 7 |
|---------------|--------------------------------|----------------------|---|-------------------------------|---|-----------------|---|
| 09:00 - 17:30 | Meet & Greet, Orientation Tour | English Lessons | Full-Day London Walking Tour (see sample tour opposite) | English Lessons | Full-Day London Walking Tour (see sample tour opposite) | English Lessons | Full-Day London Walking Tour (see sample tour opposite) |
| 20:00 - 22:00 | Welcome Evening | Building Competition | Quiz Night | Staff vs Students Competition | Twin Disco Night | Trash Fashion | Film night |

Explore the historic capital of the UK on foot

Sample London Walking Tours

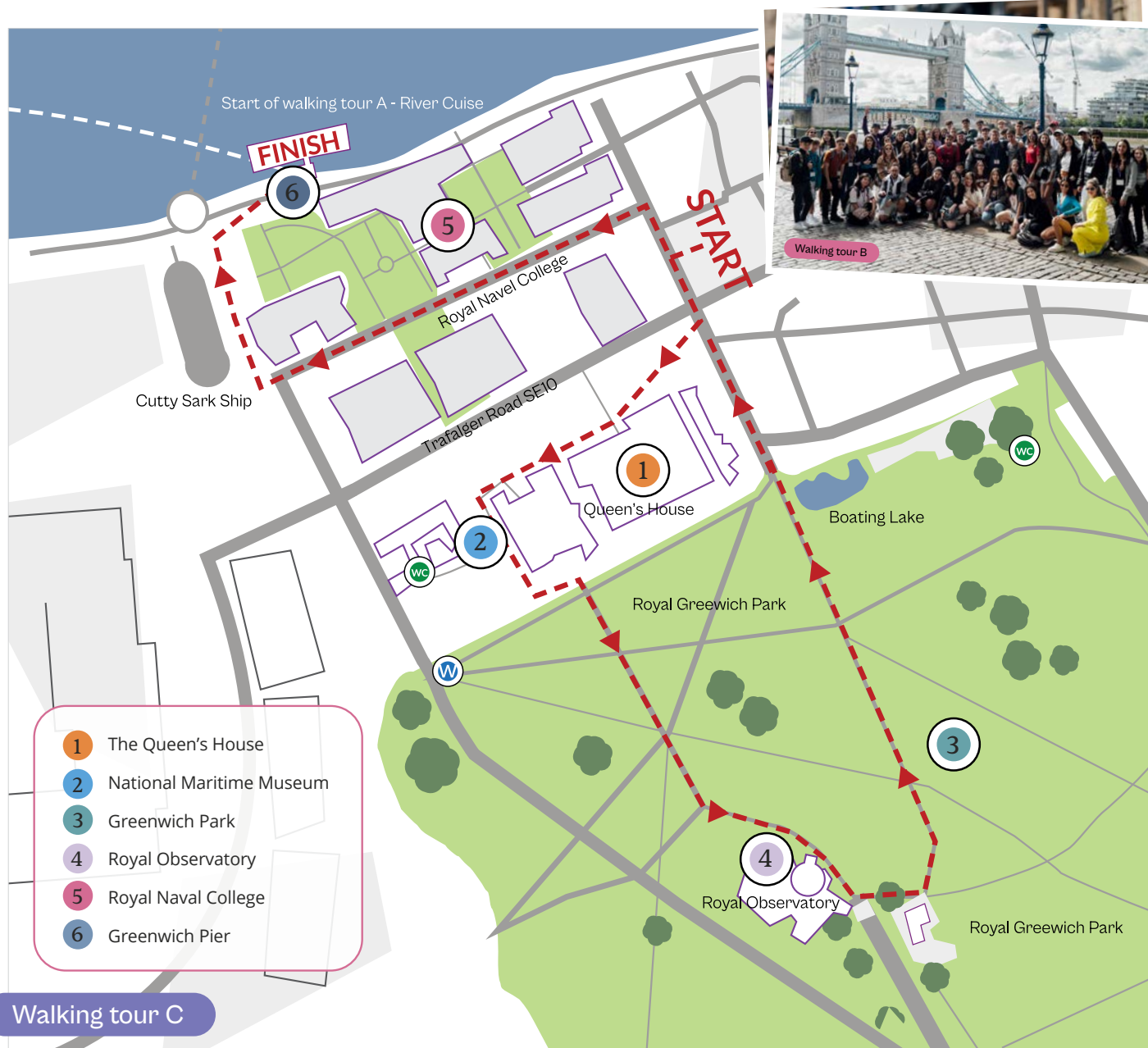

Walking Tour - A

Thames River Cruise • London Eye • Big Ben • Houses of Parliament

Walking Tour - B

Tower of London • Tower Bridge • HMS Belfast • The Southbank

Walking Tour - C

Greenwich Maritime Museum • Greenwich Park • The Royal Observatory

Walking Tour - D

Madame Tussauds • Knightsbridge • The Science Museum

Walking Tour - E

British Museum • Tottenham Court Road • Regents Street • Oxford Street

Follow tailored tour routes to see the best London has to offer



Added value at every level!

All Twin two-week (13-night) packages offer an amazing opportunity for students to learn and explore, with exciting additional excursions and activities built in at each higher level.

London Centres

At London Docklands and Kingston upon Thames

P London Platinum Package

- 5 full-day excursions to London (travelcards included)
- 1 full-day excursion to Brighton by coach
- 1 full-day excursion to Cambridge by coach
- River Cruise, London Eye, Madame Tussauds, Tower of London, Football Stadium, and Brighton Pavilion included

G London Gold Package

- 5 full-day excursions to London (travelcards included)
- 1 full-day excursion to Brighton by coach
- 1 full-day excursion to Cambridge by coach
- River Cruise, London Eye, and Brighton Pavilion included

S London Silver Package

- 5 full-day excursions to London (travelcards included)
- 1 full-day excursion to Brighton by coach
- 1 full-day excursion to Cambridge by coach
- Entrances to attractions at additional cost

B London Bronze Package

- 7 full-day excursions in London (travelcards included)
- Entrances to attractions at additional cost

It's easier than ever to book the package you want



Travelling outside London?

Packages for all other centres

At Edinburgh, Eastbourne, Royal Leamington Spa, Dublin, and Waterford, choose from:

P

Platinum Package

- 4 full-day excursions by coach
- 4 half-day excursions
- Entrances to attractions included

B

Bronze Package

- 2 full-day excursions by coach
- 2 half-day excursions
- Entrances to attractions at additional cost



Pick the right centre for you, across the UK and Ireland

London Docklands

Located at the Docklands campus of the University of East London, the centre is right next to the River Thames and close to London City Airport. From the modern residence buildings you get great views of London's iconic skyline, and easy access to central London when you want to explore the city.



Weekday Arrivals - 2024

2 Week Bookings (13 nights - 14 days)

- Wednesday 3rd July
- Tuesday 16th July
- Monday 29th July

3 Week Bookings (20 nights)

- Tuesday 9th July 2024

Centre highlights

- Centrally located in London
- Just 30 minutes from Brick Lane and Shoreditch
- Situated close to the world famous O2 arena
- Riverfront location, formerly part of the Port of London
- Discover London's historic locations through interesting walking tours
- Alternative days tuition and sightseeing



London Docklands centre information

| | |
|------------------|--|
| Student Age | 11-18* years |
| Max Bed Capacity | 300 beds |
| Room Type | Single en-suite bathroom |
| Class Location | On-site |
| Meals (on-site) | Choice of two mains + Dessert, fruit, drinks |
| Laundry | On-site (for a small fee) |

Scan the QR to visit Docklands Summer Centre web page



An ideal centre to explore the city of London

London Kingston

Kingston, meaning 'King's Town' takes its name from the large stone representing the traditional coronation place for English Kings. Kingston upon Thames is a culture-rich town in southwest London, a short journey from the centre of London, and offers a fantastic mix of history, culture and city living.

Centre highlights

- An historic part of London, located right on the River Thames
- Home of Hampton Court Palace – The former home of King Henry VIII
- Just 30 minutes from central London
- Leafy riverside walks and cafes
- Wild open areas like Richmond and Bushy parks

London Kingston centre information

| | |
|------------------|--|
| Student Age | 11-18* years |
| Max Bed Capacity | 200 beds |
| Room Type | Single en-suite bathroom |
| Class Location | University shuttle bus |
| Meals (on-site) | Choice of two mains + Dessert, fruit, drinks |
| Laundry | On-site (for a small fee) |



Scan the QR to visit Kingston Summer Centre web page

Weekday Arrivals - 2024

2 Week Bookings (13 nights - 14 days)*

- Monday 8th July
- Monday 22nd July
- Monday 5th August

3 Week Bookings (20 nights)

- Monday 8th July

*14 night stay possible with a supplementary charge



Enjoy culture-rich southwest London

Dublin

Hosted at one of Ireland's leading boarding schools, The King's Hospital school. Founded in 1669, the school occupies a stunning 40-hectare wooded site on the banks of the River Liffey. It offers beautiful views of the woods and river and is located just 20 minutes from Dublin city centre and the international airport.



Weekday Arrivals - 2024

2 Week Bookings (13 nights - 14 days)*

- Tuesday 2nd July
- Tuesday 16th July

*14 night stay possible with a supplementary charge



Centre highlights

- Heated indoor swimming pool
- Extensive sports facilities include rugby, football, volleyball pitches, basketball and tennis courts, and a state-of-the-art indoor gymnasium
- Theatre and music rooms
- Large enclosed grounds with plenty of green areas
- Easy access to Dublin city centre

Dublin centre information

| | |
|------------------|--|
| Student Age | 10-17 years |
| Max Bed Capacity | 200 beds |
| Room Type | Dormitory shared en-suite bathroom |
| Class Location | On-site |
| Meals (on-site) | Choice of two mains + Dessert, fruit, drinks |
| Laundry | On-site (for a small fee) |

Scan the QR to visit Dublin Summer Centre web page



A scenic campus, surrounded by beautiful woodland



Waterford

Founded by the Vikings in the 9th century, Waterford is one of Ireland's oldest cities. Our centre is hosted at the innovative and modern South East Technological University in the heart of the city. Easy access to beautiful beaches and many inside attractions.

Centre highlights

- Convenient city centre location
- Excellent sports facilities including football pitches, indoor hall, running track, and green spaces
- Close to beautiful ancient coastline
- Ancient city location, more than 1000 years old
- Home of the world famous Waterford Crystal

Waterford centre information

| | |
|------------------|--|
| Student Age | 12-17 years |
| Max Bed Capacity | 150 beds |
| Room Type | Single en-suite bathroom |
| Class Location | Walking distances (20 minutes) |
| Meals (on-site) | Choice of two mains + Dessert, fruit, drinks |
| Laundry | On-site (for a small fee) |

Weekday Arrivals - 2024

2 Week Bookings (13 nights - 14 days)*

- Tuesday 2nd July
- Tuesday 16th July

*14 night stay possible with a supplementary charge



Scan the QR to visit Waterford Summer Centre web page

The gateway to the southeast of Ireland

Royal Leamington Spa

Located near famous Stratford-upon-Avon, the birthplace of William Shakespeare, Royal Leamington Spa is filled with beautiful buildings, parks, and a growing creative scene. Our centre is positioned next to the River Leam and Victoria Park in the heart of the city.



Weekday Arrivals - 2024

2 Week Bookings (13 nights - 14 days)*

- Tuesday 9th July
- Tuesday 23rd July
- Tuesday 6th August

3 Week Bookings (20 nights)

- Tuesday 9th July 2024

*14 night stay possible with a supplementary charge



Centre highlights

- Located near Stratford-upon-Avon
- Just 40 minutes away from Oxford and 2 hours from London
- Walking distance to the historic town centre
- Activities in the nearby Victoria Park
- Modern facilities, including a sports hall

Royal Leamington Spa centre information

| | |
|------------------|--|
| Student Age | 10-17 years |
| Max Bed Capacity | 158 beds |
| Room Type | Single en-suite bathroom |
| Class Location | On-site |
| Meals (on-site) | Choice of two mains + Dessert, fruit, drinks |
| Laundry | On-site (for a small fee) |

Scan the QR to visit Leamington Summer Centre web page



A picturesque town famed for its regency architecture



Eastbourne

Hosted at our own 18th century English mansion which boasts an impressive guest list over the years, including Kings, Queens, and British Prime Ministers. Students can enjoy studying at a popular seaside location, in an historic building with beautiful grounds.

Centre highlights

- Great south coast location, just minutes from the beach
- Excursion choices include London and Brighton
- 10-hectare private grounds with tennis courts and football pitch
- Rich architectural and social history dating back to the Roman occupation

Eastbourne centre information

| | |
|------------------|--|
| Student Age | 8-17 years |
| Max Bed Capacity | 170 beds |
| Room Type | Dormitory room - Shared bathroom |
| Class Location | On-site |
| Meals (on-site) | Choice of two mains + Dessert, fruit, drinks |
| Laundry | On-site (for a small fee) |



Scan the QR to visit Eastbourne Summer Centre web page

Weekday Arrivals - 2024

1 Week Bookings (6 nights)

- Friday 5th July
- Friday 2nd August

2 Week Bookings (13 nights)

- Friday 14th June
- Friday 28th June
- Friday 12th July
- Friday 26th July
- Friday 9th August
- Friday 23rd August

3 Week Bookings (20 nights)

- Friday 14th June
- Friday 12th July
- Friday 9th August



Study at a summer centre with royal connections*

*Princess Elizabeth (Queen Elizabeth II) and Princess Margaret stayed here in 1946

Edinburgh

The capital city of Scotland, Edinburgh is a vibrant and historic destination for learning and leisure alike, full of iconic landmarks. Hosted at the prestigious Loretto School, this centre is a great fit for those looking for a cultural and historic experience in a beautiful city.



Weekday Arrivals - 2024

2 Week Bookings (13 nights - 14 days)*

- Thursday 4th July
- Thursday 18th July
- Thursday 1st August

4 Week Bookings (27 nights)

- Thursday 4th July

*14 night stay possible with a supplementary charge



Centre highlights

- Hosted at Scotland's oldest boarding school, established in 1827
- Stunning campus with 85 acres of grounds
- Near the world-famous Edinburgh Castle
- Great access to shopping and leisure activities
- Easily reachable coast, only a few miles away

Edinburgh centre information

| | |
|------------------|--|
| Student Age | 10-17 years |
| Max Bed Capacity | 254 beds |
| Room Type | Dormitory room - Shared bathroom |
| Class Location | On-site |
| Meals (on-site) | Choice of two mains + Dessert, fruit, drinks |
| Laundry | On-site (for a small fee) |

Scan the QR to visit Edinburgh Summer Centre web page



Our new Scottish summer centre



It's only my first day, and I'm already
very happy to be here - Vasel, Argentina



What students think

We love to see you posting on social media about your time in our centres. Check out some of the pictures and feedback from previous and current students:

Having the chance to see lots of different sights such as The London Eye, The British Museum and Chinatown - *Veronica, Italy*

They are professional; very good experience. Friendly atmosphere and fun - *Karla, Czech Republic*

I recommend Dublin with Twin for everyone ❤️ - *Przemyslaw, Poland*

We very much liked the Eastbourne campus, we learnt a lot and made friends - *Dorin, Romania*

I went sightseeing around the city and saw London Bridge, Big Ben and the O2 Arena - *Ahmed Salim, Oman*

Teachers are great. Everything is good in general - *Alhas, Turkey*

Twin Instagram

We are always pleased to be tagged in content taken by you.

If you share a photo or video of your time with us, tag us @TwinEnglishCentres and add the #TwinSummer hashtag. Every week we will share the best content in our profile.

Be part of the story!



“There is a nice student community
at Twin, a good mix of nationalities.
I felt like every student matters
- Rosie, Brazil





Accommodation

We want our students to be as comfortable and happy as possible, and we understand that living arrangements can be as important as studying. Our options are carefully chosen to make sure the standards meet our students' expectations. Our accommodation options for summer include homestay and residential, each including three meals per day.

Homestay accommodation

When students stay in homestay accommodation, they have an opportunity to practise their English outside of the classroom while living in a home environment. Our accommodation team sources friendly and welcoming homestay options in Eastbourne and Dublin. We also work with our external providers to make sure that homestay accommodation meets our high standards, and our students are safe, comfortable and happy with their host.

Residential accommodation

Our accommodation is different from centre to centre. While some centres offer single or double en-suite, others offer shared rooms and shared bathrooms. All include common areas for students to enjoy and plenty of outside space is available for activities. Students can look forward to spending more time with their new friends and sharing mealtimes.

Accommodation explained

- Bed and board included (three meals per day)
- Welcoming and comfortable environment
- Communal areas for relaxing and socialising
- Students must bring their own towel and toiletries

Making sure your stay is as comfortable as possible



Extra Services

At Twin we like to make sure we handle all of our customers' requirements. In addition to our courses, accommodation, excursions, and attractions we can also arrange:



Airport transfers meet & greet

We can make sure students have a smooth arrival and departure by taking care of their travel to and from the airport. We also offer an unaccompanied minor service for students under the age of 18.



Meals and dining experiences

From packed lunches to restaurant dining we can arrange meals for students, taking care of any special dietary requirements.

Blue badge guides

These guides are available in London only and offer tours of exceptional quality.



Culture and entertainment

We provide tickets to a number of cultural events in London, including ballets, musicals, and concerts.

Travel and medical insurance

Twin can provide travel and medical insurance through a licensed underwriter.

Let us go the extra mile to help you out

For more information about our services, please visit:

Twin Group:

twingroup.org

English Centres:

twinenglishcentres.com

School Group Travel:

twingrouptravel.com

Work Experience:

twininternships.com

Summer Centres:

twinsummercentres.com

Twin's commitment to safeguarding

The safety and well-being of students is our highest priority. Our centres are accredited by the British Council in the UK, and ACELS in Ireland, and our safeguarding standards are enforced.



Accredited by the
BRITISH COUNCIL
for the teaching
of English in the UK



TRINITY
COLLEGE LONDON

